

The FOREDE® Brand PSY80UH1 Portable Fire Monitor is suitable various application due to the Flexible which could carry by one man to different areas quickly. PSY80UH1 is good quality with competitive cost, highly welcome among customer.

FEATURES

- Light corrosion resistant aluminum alloy construction
- Elevation stream range of 90°, from +0° to +90°; Horizontal 360°
- Stainless steel folding legs
- Stainless steel spikes for extended resistance to wear
- Large handle for excellent portability
- Nozzle has a built-in stream sharper
- Available for straight stream and fog pattern
- Handwheel for elevation control
- Rotation lock device and elevation pin stop
- Long service and easy repair
- Liquid-filled pressure gauge
- Flow rate 4800 LPM, automatic nozzle
- Water Jetting Range: Max ≥75 meters
- Working Pressure: 10 bar (1.0MPa)
- Weight: 18.5kg
- Wooden Case Package: 35kg/78*45*54cm
- Color: Golden Yellow standard

MAXIMUM FLOW
1250 GPM @ 175 PSI
(4800 L/min @ 12 BAR)

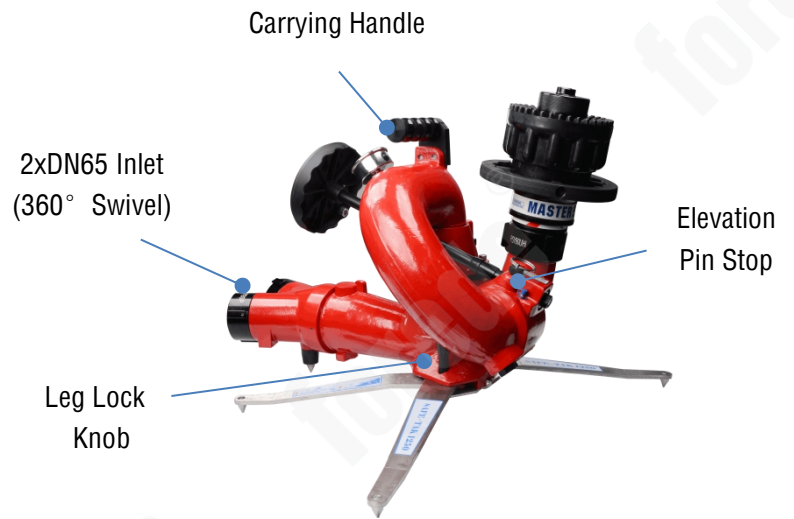
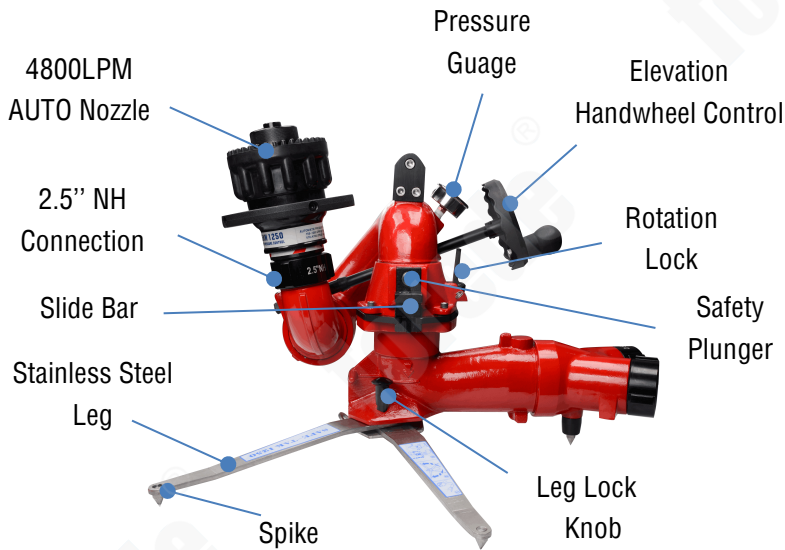

Model	PSY80UH1	Material
Flow Rate	4800LPM (Selectable Nozzle)	Body: Hard Anodized Aluminum alloy Nozzle: Hard Anodized Aluminum alloy Folding leg: Stainless Steel Spikes: Stainless Steel
Working Pressure	1.0 MPa	
Water Jetting Range	≥ 75 meters	
Max. Fog Angle	120°	
Outlet	2.5" NH Connection	
Inlet	2 Inlets, All International Coupling available	



*Understand manual before use. Operation of this device without understanding the manual and receiving proper training is a misuse of this equipment.

*Risk of sliding increases at low elevation angles. To reduce risk of injury or death from sliding, test safety elevation plunger before using.

*This Instruction Manual is intended to familiarize firefighters and maintenance personnel with the operation, servicing, and safety procedures associated with the portable monitor. This manual should be kept available to all operating and maintenance personnel.

OPERATING & BRIEF INSTRUCTIONS

INSTALLING THE MONITOR TOP ON THE BASE

To install the monitor on portable base:

1. Turn elevation handwheel to make sure the elevation of the nozzle is above the 35° safety stop. Verify that the elevation stop pin is down and engaged.
2. Make sure the slide bar is in the up position.
3. Holding the monitor by the top carrying handle, position monitor over base and slide straight down.
4. Push the slide bar down and watch the pawls engage the groove in the base and the safety plunger engage in the hole in the slide bar.

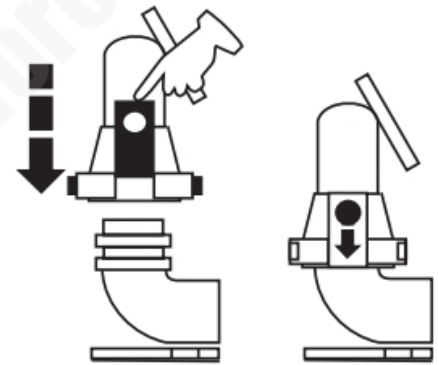

- Hold monitor over base and lower straight down. Push Slide Bar DOWN to engage the plunger and pawls.



Slide Bar in the UP position.

REMOVE THE MONITOR TOP ON THE BASE

To remove the monitor top from the truck mount flange or portable base:

1. Stop all water flow to the monitor.
2. Depress the safety plunger to disengage the spring-loaded pawls from the groove in the base.
3. Holding the monitor by the top carrying handle, lift the monitor straight up off the base.

POSITIONING STREAM - HORIZONTAL ROTATION AND LOCK

The monitor can be rotated horizontally on the base to a desired position. The rotational position of the monitor must be locked before flowing water. When not rotating the monitor on the base, keep the rotation locked.

To position the monitor horizontally:

1. With the monitor on the base, rotate the monitor to a desired position.
2. Lock the rotational position by moving the rotation lock lever to the down position.
3. Manually unlock the rotational lock by moving the rotation lock lever to the up Position before repositioning or removing the monitor from the base. A small spring holds the lever in the up (unlocked) position.

WARNING: To avoid a sliding monitor, when used on a portable base, keep the horizontal angle between the water stream and the anchor strap as small as possible. At large angles, the base can slide in an arc around the anchor point which can result in injury or death if struck by the monitor or water stream.



LOCKED



UNLOCKED

POSITIONING STREAM - ELEVATION CONTROL AND STOP PIN

The handwheel controls nozzle elevation.

- Clockwise rotation of the wheel will raise the nozzle.
- Counter-clockwise rotation of the wheel will lower the nozzle.

When mounted on a truck base, the nozzle may be lowered below the 35° safety stop by pulling out the stop pin and rotating the handwheel below the 35° stop. When the nozzle is raised back above 35°, the spring loaded stop pin snaps back into position, automatically limiting the elevation of the nozzle with respect to the base to 35°.

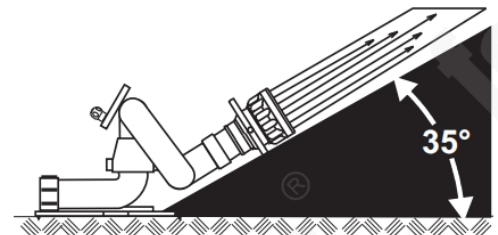

WARNING: Low nozzle elevation angles can cause portable monitors to slide or lift off the ground which can result in injury or death from an out of control monitor. Do not operate the monitor below the elevation safety stop while on the portable base.



Elevation Handwheel Control



Elevation Pin Stop

FOLDING LEG OPERATION

The portable base legs are extended by following these steps:

1. Hold the base carrying handle with one hand and grasp the end of one of the longer legs with the other hand.
2. Pull this leg away from the base forward in an arc, until the locking pin engages. The locking pin is spring loaded and automatically engages when the legs are in the correct position. Watch the leg lock knob drop down even with the lower band on the base, indicated by an arrow.
3. Repeat steps 1 & 2 for the other set of legs.
4. Set portable base on even ground with all leg spikes in contact with the ground.
5. Lift the storage cap to remove the anchor strap stored inside the base. Keep the strap near the monitor as it will be used to tie off the monitor before use.

To retract the legs for carrying or storage:

1. Pull up on one of the spring loaded leg lock knobs to disengage.
2. Grasp the forward leg on the same side as the knob and push it in an arc, towards the rear of the unit. The leg lock knob may be released as soon as the front leg begins to move out of position.
3. Continue to push until both legs come in contact with the rear stop.
4. Repeat steps 1, 2, & 3 for the other set of legs.

WARNING: In the unfolded position, the legs provide a stable base for operation of the monitor. Lack of stability can cause an out of control monitor resulting in injury or death. Do not operate as a portable monitor with one or both legs in the folded position.

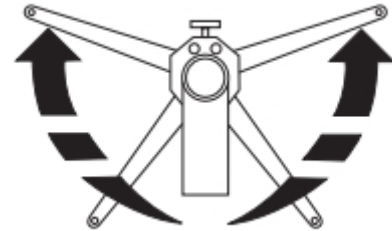

AUTOMATIC, CONSTANT, SELECTABLE FLOW NOZZLES

The FOREDE[®] PSY Portable Monitor could attached a variety of water/ water&foam nozzle.

This instruction main for Automatic flow nozzle, if you have special requirements, Please view our website to contact our sales team for more info - www.forede.com

OPERATIONAL REQUIREMENTS & PRECAUTIONS

- ❖ The personnel operating the fire monitor must be trained in operation and be familiar with the relevant operation process.
- ❖ The inlet pressure of water shall not be higher than the working pressure of the monitor.
- ❖ Before using the fire monitor, all personnel in front of the muzzle should be evacuated to avoid danger.
- ❖ When manually operating the fire monitor, please take the handle to avoid danger.
- ❖ When operating, it should be jetted downwind as far as possible to increase the range.

MAINTENANCE

*The maintenance of fire monitors should be handled by dedicated personnel.

- ❖ The fire monitor should be kept clean. After use, the nozzle should be tilted to pour out the remaining liquid in the cavity, and the exterior should be cleaned with clean water and wiped off the water stains. Dual-purpose monitor(water/foam), the interior must be rinsed with clean water, and then the accumulated water must be released.
- ❖ The fire monitor should be maintained regularly, and all fasteners of the fire monitor should be inspected after use and every six months.
- ❖ The meshing part of the worm gear and other rotating parts should be filled with grease for half a year to ensure flexible rotation.
- ❖ All parts should be kept in good condition. If the fasteners are found to be loose and other accessories are damaged, they should be repaired in time.
- ❖ When not in use, cover it with a rain-proof cloth. The unit should be stored in a normal temperature, dry and non-corrosive place.
- ❖ When the working pressure of the fire monitor is found to be too high or the shooting range is short, check whether there is any blockage at the nozzle, and clear it in time.
- ❖ If there is leakage at each connection part of the fire monitor, check whether the seal is intact, and replace the seal in time if damaged.
- ❖ The rotating part of the fire monitor is not flexible, the operation is difficult, or the angle adjustment cannot reach the expected range, grease should be applied to the rotating part or the parts should be replaced in time.
- ❖ In cold areas, take measures to prevent cold and frost, such as drainage and heat preservation.
- ❖ When the fire monitor is used as the vehicle monitor of a fire truck, should be fixed to prevent bumps during driving and damage to the monitor parts.

ORDERING GUIDE

- Model Number
- Inlet Connection way, size and standard.
- Order Quantity
- Shipping/Transportation Way

*Other special requirements please contact FOREDE SALES TEAM.

Tips: for more related products or other firefighting equipment, please forward to our website, www.forede.com